

# LuminAir® Fan & Light



## Features and Benefits

- > The original fan and light combination.
- > For complete ducted kits, see pages 34-35.
- > IPX7 rated.
- > Suitable for shower enclosures and wet areas - can be used within reach of a person using a bath or shower.
- > Safety extra low voltage (SELV).
- > Easy installation.

## Safety Extra Low Voltage

The revolutionary Vent-Axia LuminAir Safety Extra Low Voltage fan and light in a single ceiling mounted fitting.

The IPX7 unit is installed directly over a shower in complete safety. Vent-Axia LuminAir extracts moisture and humidity at source, preventing damaging condensation from spreading. At the same time it bathes the shower enclosure in a rich soft light - bringing any dark shower to life. Ideal for all types of bathroom and shower applications, and is particularly suitable for bedsit and en-suite shower installations.

Designed for mounting in a wide variety of ceiling thicknesses. The safety isolating

transformer to BS EN 60742 is mounted in a purpose made enclosure that can be wall mounted or sited in the loft, and is designed to accept mini trunking (LuminAir L transformer - IP20 - loft mounted).

LuminAir has a 20 Watt 40° spread, pre-formed Dichroic Multi-Mirror™ lamp, to give a pool of soft warm light. The lamp has a long life and is simple to change.

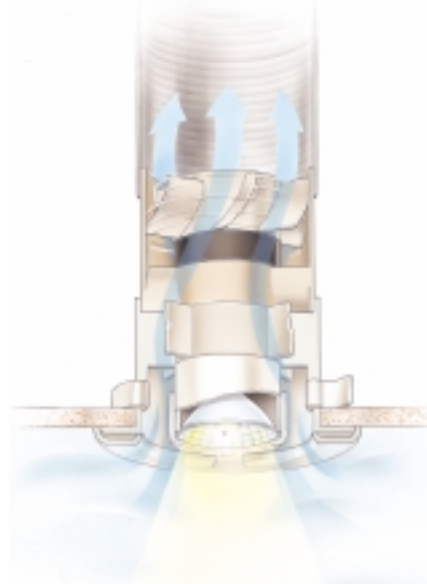

Sectional view of LuminAir

European Patent No. EP0730716  
Australian Patent No. 677461  
South African Patent No. 94/8865  
Other world patents applied for

## Models

### LuminAir L - Fan & light.

Provides simultaneous fan and light operation from the bathroom light switch.

Stock Ref. No. 18 81 10

### LuminAir T (Timer) - Fan & light.

Switches the fan On with the light. When the light is switched Off, the fan continues to run for an adjustable set period to meet the building regulations for internal bathrooms.

Stock Ref. No. 18 82 10

### LuminAir H (Humidity) - Fan & light.

Combines a light activated by the bathroom light switch and an Ecotronic Humidity Sensor which will switch the fan 'On' whenever the humidity level warrants.

Stock Ref. No. 18 86 10

Supply to the LuminAir transformer 220-240V/1/50Hz.  
Output to LuminAir 12V SELV/1/50Hz. Safety isolating transformers conform to BS EN 60742.



Stylish Chrome or Gold Bezels are also available.

## LuminAir Vent Light

Illuminated air inlet for powered ducted systems

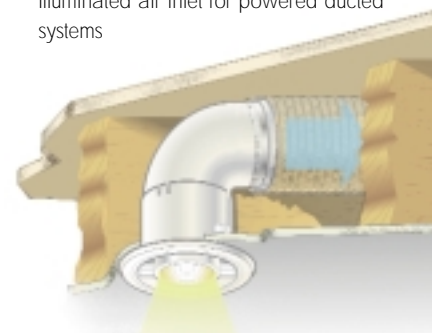

LuminAir Vent Light installation

For upgrading existing extract systems or to provide multiple extract points to a central fan. The Vent Light consists of a LuminAir Safety Extra Low Voltage (SELV) light with white ceiling bezel and 90° bend. The bend is especially suitable for connection to extract ductwork runs between joists. On/Off operation is via the bathroom light switch. Gold and silver bezels are available as accessories.

Stock Ref. No. 45 33 95 - White

## Typical Specification

Supply and install a Luminair Safety Extra Low Voltage (SELV) in line fan and light combination as manufactured by Vent-Axia Ltd, Fleming Way, Crawley, West Sussex, RH10 9YX, Telephone 01293 526062. When installed the fan complies with the 16th edition of IEE Regulations (BS7671), 2001) and an on site guide for Safety Extra Low Voltage (SELV) operation. The transformer should be safety insulating to BS EN 60742. The fan should be rated to IPX7. The fan and transformer should be BEAB approved.

The fan performance should meet the Building Regulation (Document F) requirements.

The motor should be manufactured with self aligning sleeve bearings and fitted with Standard Thermal Overload Protection, (S.T.O.P.) the motor should be insulated to Class B and designed to operate on SELV 12V/1/50Hz.

Operation:

- Luminair L - via light switch
- Luminair T - via light switch with timer overrun facility
- Luminair H - with adjustable humidity sensor

Type	LuminAir Stock Ref. No.	Amps @ 240V	Free Air Extract performance		Max Watts	dB(A) @ 3m	Bezel Accessory Colour	
			m³/h	l/s			Stock Ref. No. Chrome	Stock Ref. No. Gold
LuminAir L	18 81 10	0.2	110	31	40	35	45 20 44	45 20 45
LuminAir T	18 82 10	0.2	110	31	42	35	45 20 44	45 20 45
LuminAir H	18 86 10	0.2	110	31	44	35	45 20 44	45 20 45

## Performance

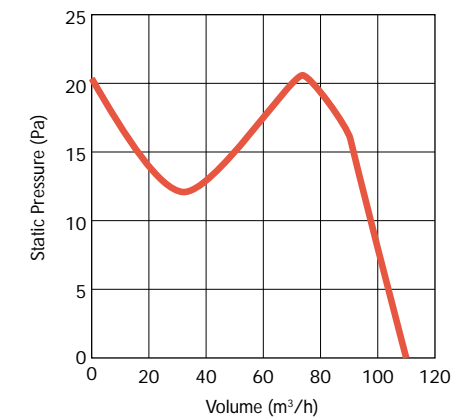

## Dimensions (mm)

	A	B	C	D	E	F	G
LuminAir	150	140	98	103	150	10	180
Transformer (T&H)	175	90	55	30			
Transformer (L)	83	76	70	61			
Humidity Sensor	87	33					

Fixing hole diameter 110mm

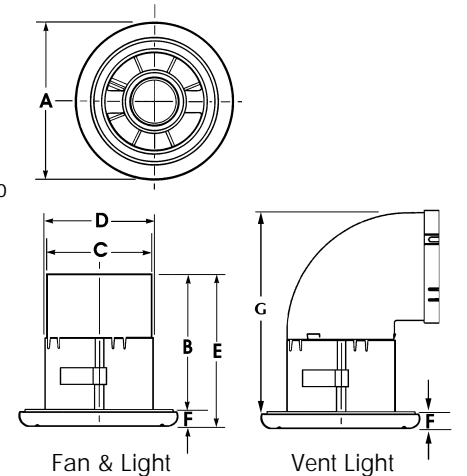

## Accessories

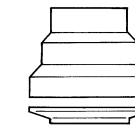

Soffit termination set  
Stock Ref. No. 56 35 13

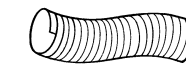

100mm Flexible ducting  
Stock Ref. No. 56 36 04 (3m length)

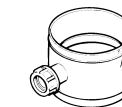

100mm Condensation trap  
Stock Ref. No. 56 35 16

For installation details see page 19.

For Wiring Diagrams see pages 227 and 229.

## Transformer/Control (T & H)

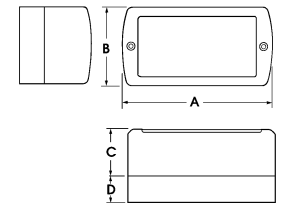

## LuminAir Transformer (L)

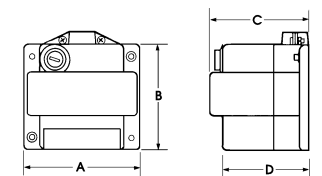

## Humidity Sensor (H)

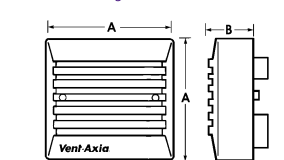

Manufacturers of some fluorescent/low energy lighting systems indicate that these can interfere with other electronic/timing circuits. For reliable operation of these circuits we recommend therefore that a tungsten filament light is used.

## FAQ's Answered

The max. length of 1.5mm² cable between Transformer and fan is 8 metres.

All controls are included, no extra sensors needed.

Roof, wall and soffit terminations can be used.

Clearance above the ceiling for the fan and light model must be at least 180mm when using the 90° bend.

Maximum 20W sealed lamp to be used (as supplied).